

急傾斜地の崩壊区域調書

様式5-4 危害のおそれのある土地等の座標位置図

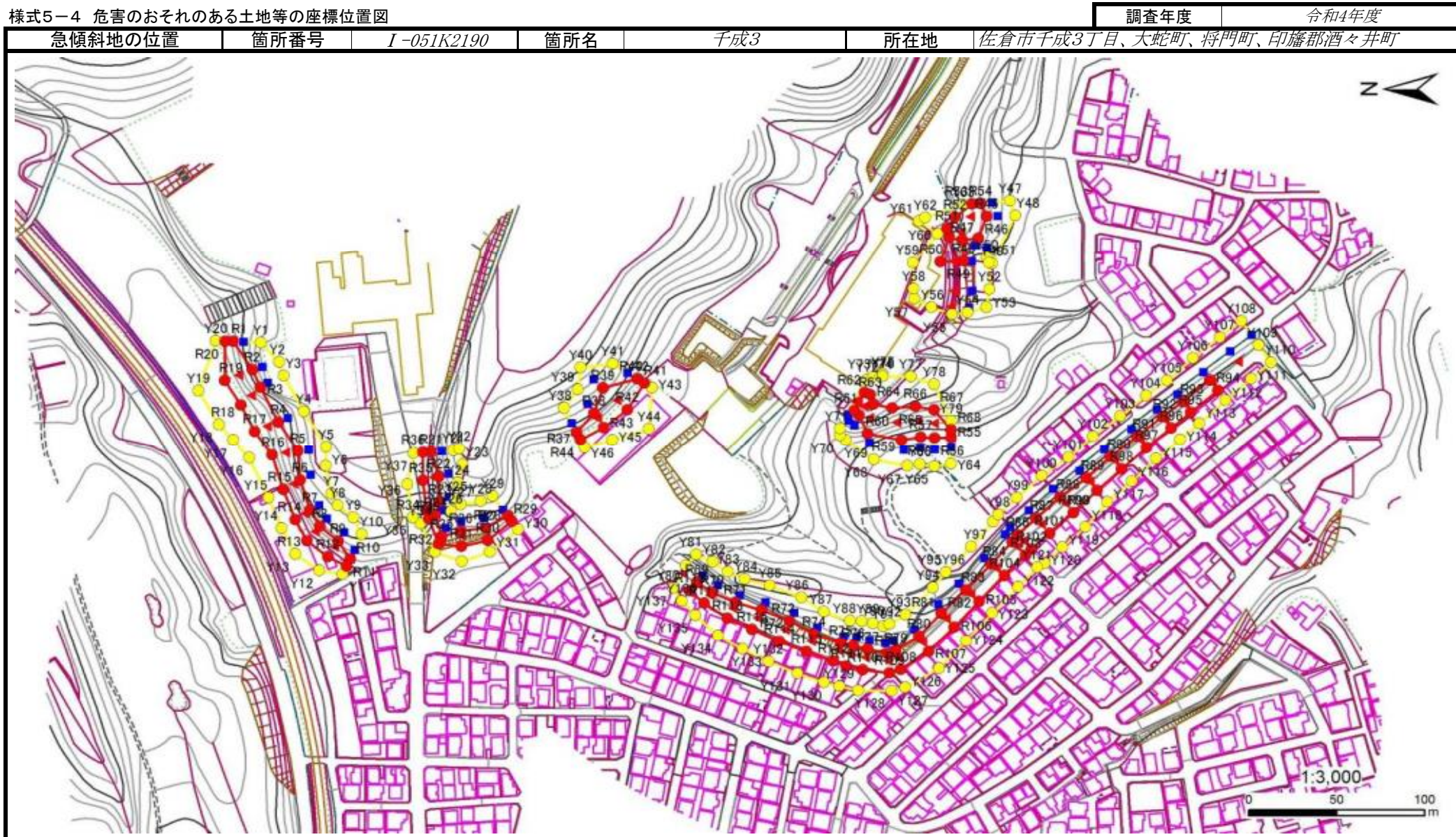

急傾斜地の崩壊区域調書

様式5-5 危害のおそれのある土地の座標一覧

| | |
|--------------------------|-------|
| 調査年度 | 令和4年度 |
| 佐倉市千成3丁目、大蛇町、将門町、印旛郡酒々井町 | |

| | | | | | |
|---------|------|------------|-----|-----|-----|
| 急傾斜地の位置 | 箇所番号 | I-051K2190 | 箇所名 | 千成3 | 所在地 |
|---------|------|------------|-----|-----|-----|

| 危害のおそれのある区域の座標(土砂災害警戒区域) | | | | | | 著しい危害のおそれのある区域の座標(土砂災害特別警戒区域) | | | | | |
|--------------------------|-----------|----------|------|-----------|----------|-------------------------------|-----------|----------|------|-----------|----------|
| 地点記号 | X(m) | Y(m) | 地点記号 | X(m) | Y(m) | 地点記号 | X(m) | Y(m) | 地点記号 | X(m) | Y(m) |
| Y01 | -30292.99 | 37336.27 | Y31 | -30423.26 | 37212.41 | R01 | -30277.20 | 37336.93 | R31 | -30407.08 | 37215.89 |
| Y02 | -30303.43 | 37324.72 | Y32 | -30407.32 | 37206.96 | R02 | -30288.19 | 37320.29 | R32 | -30394.10 | 37217.45 |
| Y03 | -30305.91 | 37316.58 | Y33 | -30391.99 | 37212.46 | R03 | -30292.78 | 37309.94 | R33 | -30388.30 | 37232.15 |
| Y04 | -30317.39 | 37295.57 | Y34 | -30383.54 | 37229.37 | R04 | -30302.70 | 37289.35 | R34 | -30386.78 | 37237.39 |
| Y05 | -30330.05 | 37274.49 | Y35 | -30379.27 | 37232.93 | R05 | -30313.88 | 37272.15 | R35 | -30385.08 | 37254.78 |
| Y06 | -30329.76 | 37263.29 | Y36 | -30376.17 | 37252.35 | R06 | -30315.15 | 37254.93 | R36 | -30385.05 | 37271.37 |
| Y07 | -30333.17 | 37246.90 | Y37 | -30379.78 | 37271.00 | R07 | -30320.91 | 37237.11 | R37 | -30472.56 | 37283.15 |
| Y08 | -30336.62 | 37239.91 | Y38 | -30465.30 | 37297.74 | R08 | -30326.36 | 37227.74 | R38 | -30482.46 | 37294.59 |
| Y09 | -30345.42 | 37232.84 | Y39 | -30473.39 | 37308.67 | R09 | -30336.76 | 37218.89 | R39 | -30487.44 | 37309.64 |
| Y10 | -30350.32 | 37222.89 | Y40 | -30474.87 | 37321.40 | R10 | -30343.64 | 37208.35 | R40 | -30507.04 | 37314.94 |
| Y11 | -30339.46 | 37199.26 | Y41 | -30493.10 | 37323.78 | R11 | -30341.68 | 37204.09 | R41 | -30511.06 | 37312.40 |
| Y12 | -30326.13 | 37201.74 | Y42 | -30507.04 | 37314.94 | R12 | -30331.14 | 37209.82 | R42 | -30501.42 | 37296.56 |
| Y13 | -30312.52 | 37211.32 | Y43 | -30515.48 | 37309.59 | R13 | -30319.17 | 37219.21 | R43 | -30487.94 | 37286.06 |
| Y14 | -30304.52 | 37226.49 | Y44 | -30513.58 | 37285.18 | R14 | -30312.44 | 37231.62 | R44 | -30474.67 | 37278.90 |
| Y15 | -30297.12 | 37244.62 | Y45 | -30492.77 | 37278.57 | R15 | -30305.50 | 37249.41 | R45 | -30706.03 | 37411.00 |
| Y16 | -30286.21 | 37268.13 | Y46 | -30477.01 | 37274.19 | R16 | -30299.30 | 37270.03 | R46 | -30701.21 | 37397.91 |
| Y17 | -30277.05 | 37278.50 | Y47 | -30719.04 | 37420.17 | R17 | -30289.42 | 37283.74 | R47 | -30691.88 | 37396.97 |
| Y18 | -30269.03 | 37287.74 | Y48 | -30722.13 | 37411.41 | R18 | -30281.59 | 37299.48 | R48 | -30692.71 | 37384.42 |
| Y19 | -30257.37 | 37307.79 | Y49 | -30708.92 | 37382.97 | R19 | -30272.45 | 37313.90 | R49 | -30679.50 | 37383.94 |
| Y20 | -30267.21 | 37337.34 | Y50 | -30705.84 | 37386.55 | R20 | -30272.56 | 37337.12 | R50 | -30684.73 | 37398.82 |
| Y21 | -30402.47 | 37272.59 | Y51 | -30707.16 | 37383.38 | R21 | -30389.75 | 37271.70 | R51 | -30683.27 | 37403.76 |
| Y22 | -30405.72 | 37273.41 | Y52 | -30707.47 | 37367.68 | R22 | -30394.23 | 37257.27 | R52 | -30687.98 | 37410.53 |
| Y23 | -30407.84 | 37264.06 | Y53 | -30705.75 | 37356.99 | R23 | -30394.66 | 37242.06 | R53 | -30697.66 | 37418.22 |
| Y24 | -30404.99 | 37253.34 | Y54 | -30695.13 | 37353.92 | R24 | -30392.17 | 37234.41 | R54 | -30702.41 | 37418.65 |
| Y25 | -30403.69 | 37243.80 | Y55 | -30686.26 | 37352.89 | R25 | -30395.89 | 37221.67 | R55 | -30685.67 | 37280.03 |
| Y26 | -30401.17 | 37236.31 | Y56 | -30674.37 | 37356.97 | R26 | -30406.83 | 37225.06 | R56 | -30676.13 | 37279.87 |
| Y27 | -30406.84 | 37240.59 | Y57 | -30664.84 | 37362.03 | R27 | -30420.73 | 37226.70 | R57 | -30668.22 | 37280.25 |
| Y28 | -30417.94 | 37242.55 | Y58 | -30664.35 | 37367.95 | R28 | -30433.28 | 37233.85 | R58 | -30657.52 | 37278.68 |
| Y29 | -30424.79 | 37245.61 | Y59 | -30664.08 | 37383.39 | R29 | -30435.65 | 37230.57 | R59 | -30638.14 | 37282.42 |
| Y30 | -30439.13 | 37225.74 | Y60 | -30678.00 | 37400.57 | R30 | -30422.02 | 37219.42 | R60 | -30633.35 | 37293.21 |

急傾斜地の崩壊区域調書

様式5-5 危害のおそれのある土地の座標一覧

| | |
|--------------------------|-------|
| 調査年度 | 令和4年度 |
| 佐倉市千成3丁目、大蛇町、将門町、印旛郡酒々井町 | |

| | | | | | |
|---------|------|------------|-----|-----|-----|
| 急傾斜地の位置 | 箇所番号 | I-051K2190 | 箇所名 | 千成3 | 所在地 |
|---------|------|------------|-----|-----|-----|

| 危害のおそれのある区域の座標(土砂災害警戒区域) | | | | | | 著しい危害のおそれのある区域の座標(土砂災害特別警戒区域) | | | | | |
|--------------------------|-----------|----------|------|-----------|----------|-------------------------------|-----------|----------|------|-----------|----------|
| 地点記号 | X(m) | Y(m) | 地点記号 | X(m) | Y(m) | 地点記号 | X(m) | Y(m) | 地点記号 | X(m) | Y(m) |
| Y61 | -30667.41 | 37408.19 | Y91 | -30647.14 | 37168.54 | R61 | -30630.44 | 37296.01 | R91 | -30805.85 | 37292.58 |
| Y62 | -30670.95 | 37410.09 | Y92 | -30650.67 | 37169.88 | R62 | -30636.34 | 37306.70 | R92 | -30817.51 | 37301.51 |
| Y63 | -30692.45 | 37417.74 | Y93 | -30659.72 | 37175.49 | R63 | -30639.72 | 37305.40 | R93 | -30833.00 | 37314.07 |
| Y64 | -30685.69 | 37264.52 | Y94 | -30675.18 | 37191.36 | R64 | -30641.55 | 37300.02 | R94 | -30837.59 | 37307.96 |
| Y65 | -30676.24 | 37263.16 | Y95 | -30682.63 | 37200.69 | R65 | -30652.19 | 37297.54 | R95 | -30822.09 | 37295.13 |
| Y66 | -30667.84 | 37264.24 | Y96 | -30696.96 | 37215.66 | R66 | -30665.38 | 37298.58 | R96 | -30810.92 | 37285.73 |
| Y67 | -30660.62 | 37263.26 | Y97 | -30709.49 | 37230.34 | R67 | -30676.02 | 37296.69 | R97 | -30796.87 | 37274.25 |
| Y68 | -30641.62 | 37267.23 | Y98 | -30712.45 | 37234.59 | R68 | -30685.67 | 37284.58 | R98 | -30782.61 | 37261.50 |
| Y69 | -30625.77 | 37278.69 | Y99 | -30723.08 | 37244.60 | R69 | -30541.16 | 37194.80 | R99 | -30768.68 | 37248.94 |
| Y70 | -30622.41 | 37281.50 | Y100 | -30737.17 | 37257.44 | R70 | -30549.76 | 37188.76 | R100 | -30755.20 | 37235.74 |
| Y71 | -30622.26 | 37285.34 | Y101 | -30752.39 | 37268.33 | R71 | -30563.04 | 37182.80 | R101 | -30741.77 | 37223.47 |
| Y72 | -30637.92 | 37314.39 | Y102 | -30766.42 | 37280.99 | R72 | -30577.84 | 37178.35 | R102 | -30731.47 | 37214.05 |
| Y73 | -30641.52 | 37316.07 | Y103 | -30781.85 | 37292.88 | R73 | -30593.72 | 37171.83 | R103 | -30727.94 | 37210.60 |
| Y74 | -30645.40 | 37316.28 | Y104 | -30796.67 | 37304.96 | R74 | -30607.73 | 37164.02 | R104 | -30716.16 | 37198.59 |
| Y75 | -30646.73 | 37317.61 | Y105 | -30808.64 | 37313.87 | R75 | -30622.82 | 37158.56 | R105 | -30701.53 | 37183.29 |
| Y76 | -30646.83 | 37316.46 | Y106 | -30823.26 | 37327.06 | R76 | -30629.97 | 37157.04 | R106 | -30687.34 | 37168.03 |
| Y77 | -30662.66 | 37316.10 | Y107 | -30838.48 | 37339.29 | R77 | -30638.02 | 37155.16 | R107 | -30672.84 | 37153.52 |
| Y78 | -30675.93 | 37311.56 | Y108 | -30850.76 | 37348.88 | R78 | -30649.06 | 37152.71 | R108 | -30656.89 | 37142.81 |
| Y79 | -30685.67 | 37290.03 | Y109 | -30860.74 | 37334.63 | R79 | -30654.24 | 37154.34 | R109 | -30650.48 | 37140.97 |
| Y80 | -30534.67 | 37204.44 | Y110 | -30867.73 | 37324.63 | R80 | -30667.35 | 37162.70 | R110 | -30635.43 | 37142.75 |
| Y81 | -30540.68 | 37210.91 | Y111 | -30856.29 | 37314.90 | R81 | -30680.13 | 37176.54 | R111 | -30626.04 | 37144.98 |
| Y82 | -30550.04 | 37206.77 | Y112 | -30841.93 | 37302.17 | R82 | -30694.02 | 37190.21 | R112 | -30618.57 | 37148.10 |
| Y83 | -30558.62 | 37200.96 | Y113 | -30826.90 | 37288.44 | R83 | -30708.53 | 37205.37 | R113 | -30603.44 | 37153.58 |
| Y84 | -30568.37 | 37196.46 | Y114 | -30816.02 | 37278.84 | R84 | -30720.47 | 37218.59 | R114 | -30587.76 | 37159.75 |
| Y85 | -30582.52 | 37192.80 | Y115 | -30802.25 | 37267.58 | R85 | -30723.35 | 37222.82 | R115 | -30572.42 | 37166.88 |
| Y86 | -30600.52 | 37185.63 | Y116 | -30788.59 | 37254.30 | R86 | -30733.78 | 37232.50 | R116 | -30558.33 | 37173.39 |
| Y87 | -30613.18 | 37177.27 | Y117 | -30774.59 | 37241.91 | R87 | -30747.50 | 37245.01 | R117 | -30545.04 | 37182.26 |
| Y88 | -30628.21 | 37171.83 | Y118 | -30762.16 | 37227.36 | R88 | -30762.50 | 37256.30 | R118 | -30537.13 | 37189.55 |
| Y89 | -30634.75 | 37171.73 | Y119 | -30748.99 | 37215.32 | R89 | -30776.41 | 37268.97 | | | |
| Y90 | -30641.18 | 37170.29 | Y120 | -30738.88 | 37206.05 | R90 | -30791.52 | 37280.89 | | | |

急傾斜地の崩壊区域調書

様式5-5 危害のおそれのある土地の座標一覧

| | |
|------|--------------------------|
| 調査年度 | 令和4年度 |
| 所在地 | 佐倉市千成3丁目、大蛇町、将門町、印旛郡酒々井町 |

| | | | | | |
|---------|------|------------|-----|-----|-----|
| 急傾斜地の位置 | 箇所番号 | I-051K2190 | 箇所名 | 千成3 | 所在地 |
|---------|------|------------|-----|-----|-----|

| 危害のおそれのある区域の座標(土砂災害警戒区域) | | | | | | 著しい危害のおそれのある区域の座標(土砂災害特別警戒区域) | | | | | |
|--------------------------|-----------|----------|------|------|------|-------------------------------|------|------|------|------|------|
| 地点記号 | X(m) | Y(m) | 地点記号 | X(m) | Y(m) | 地点記号 | X(m) | Y(m) | 地点記号 | X(m) | Y(m) |
| Y121 | -30734.76 | 37203.30 | | | | | | | | | |
| Y122 | -30723.64 | 37191.94 | | | | | | | | | |
| Y123 | -30708.89 | 37176.52 | | | | | | | | | |
| Y124 | -30694.34 | 37159.93 | | | | | | | | | |
| Y125 | -30678.74 | 37143.63 | | | | | | | | | |
| Y126 | -30659.34 | 37132.16 | | | | | | | | | |
| Y127 | -30651.80 | 37130.12 | | | | | | | | | |
| Y128 | -30632.88 | 37130.55 | | | | | | | | | |
| Y129 | -30622.19 | 37133.13 | | | | | | | | | |
| Y130 | -30613.34 | 37135.24 | | | | | | | | | |
| Y131 | -30598.16 | 37140.73 | | | | | | | | | |
| Y132 | -30581.82 | 37147.69 | | | | | | | | | |
| Y133 | -30566.92 | 37155.25 | | | | | | | | | |
| Y134 | -30553.14 | 37163.02 | | | | | | | | | |
| Y135 | -30539.99 | 37175.30 | | | | | | | | | |
| Y136 | -30532.52 | 37183.56 | | | | | | | | | |
| Y137 | -30527.64 | 37191.22 | | | | | | | | | |
| | | | | | | | | | | | |
| | | | | | | | | | | | |
| | | | | | | | | | | | |
| | | | | | | | | | | | |
| | | | | | | | | | | | |
| | | | | | | | | | | | |
| | | | | | | | | | | | |
| | | | | | | | | | | | |
| | | | | | | | | | | | |
| | | | | | | | | | | | |
| | | | | | | | | | | | |
| | | | | | | | | | | | |